

# RE<sup>THINK</sup>





How the humble light switch has evolved. Now featuring innovative technology and sophisticated design, you'll be surprised how electrical accessories including switches, sockets, lighting, intercoms, fans, and home automation, can enhance your surroundings and increase your comfort at home.

So **RETHINK** your electrical: choose fixtures and fittings to suit the life you've always wanted, and finesse your interiors with endless possibilities of colour, style and function. Remember, life is in the details.

PUSH-BUTTON  
DIMMER  
REDEFINE  
LIGHT SWITCH  
DESIGN



Legrand Arteor Electronic Push-button Dimmer Graphite

Combine function and luxury to create the ultimate space for relaxation.

RETHINK:  
THE POSSIBILITIES

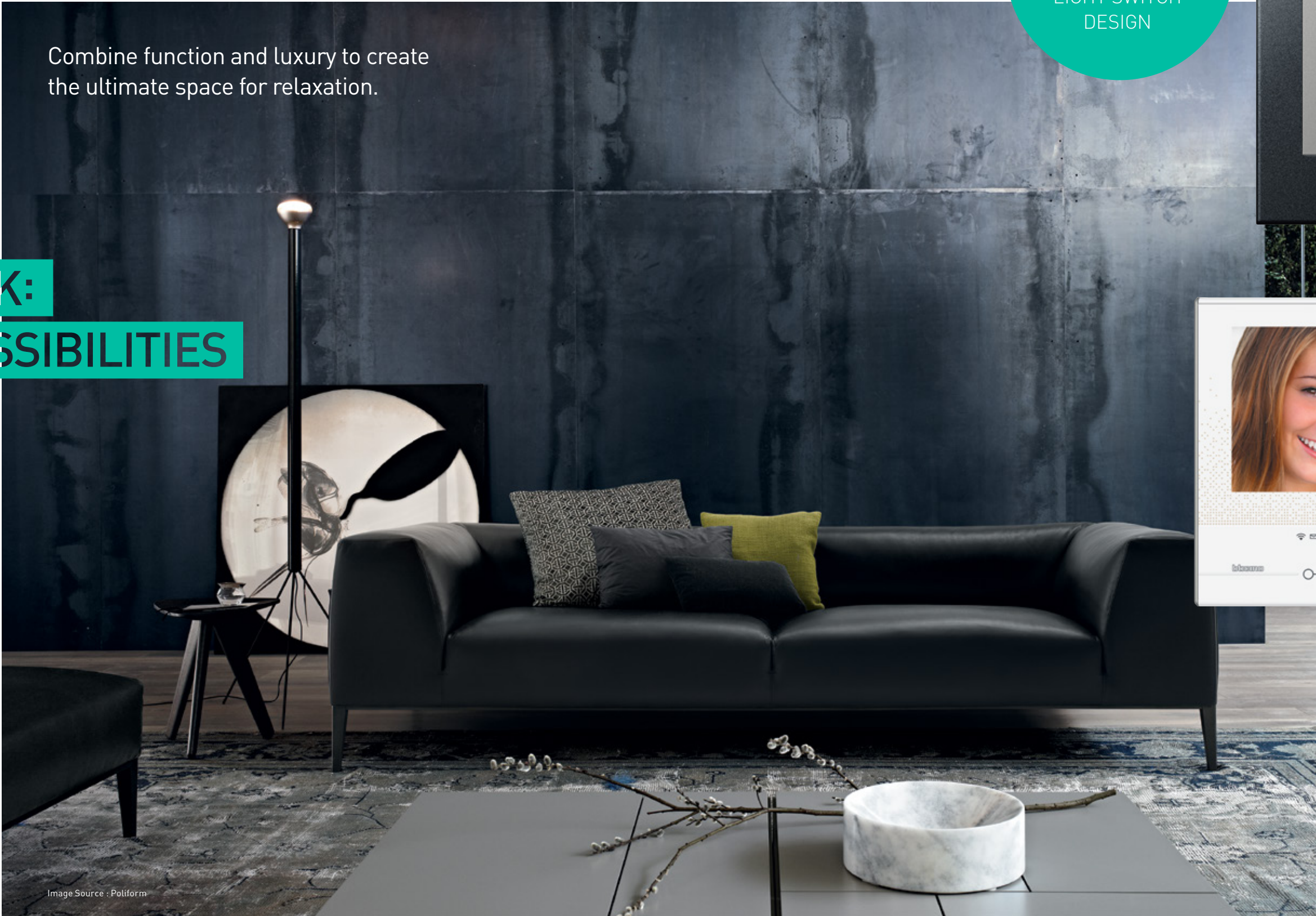
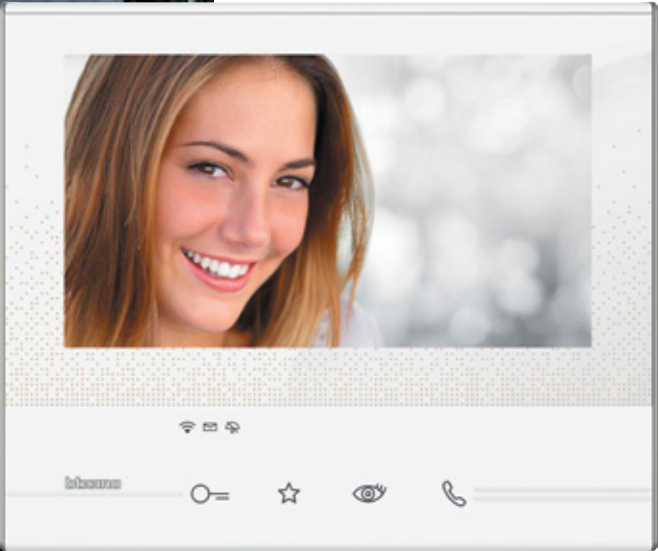

Image Source : Poliform



BTicino Classe 300 Wifi Intercom



# KEEPING YOU COMFORTABLE AND CONNECTED



Life is about feeling comfortable and connected. In this brochure we'll show you a snapshot of our electrical accessories available to enhance your home and make it more beautiful, energy efficient, and relaxing. Plus there is a quick guide to the best products for each room.

**RETHINK** your electrical plan so you are comfortable and connected both now and in the future as your family grows and changes.



Legrand Arteor 3.5" Energy Monitoring Touchscreen Mirror White



HPM Linea Extra- Safe Powerpoint Abracadabra



Legrand Excel Life Powerpoint & USB Charger White

“The living space is never unfinished and never finished.  
It lives with those who live within.”

MIES VAN DER ROHE Architect

# RANGE SNAPSHOT

## ARTEOR

For style seekers, tech enthusiasts and lovers of high quality materials and craftsmanship, Arteor is the ultimate collection.



Round Switch Wenge Wood    Square Switch Mirror Black    Wireless Switch White    Bluetooth Sound Player Stainless Steel    Electronic Push-button Dimmer Mirror Red    Double Powerpoint Type A + C USB Charger Mirror Black

### FINISHES



View the full Arteor range at [legrand.com.au](http://legrand.com.au) or [legrand.co.nz](http://legrand.co.nz)

## LINEA

Celebrate colour and express your individual style. Bold, striking, soothing, happy, refreshing – choose the colour for your character. Energise your interiors with Linea.



Electronic Push-button Switch Wet Elephant    Electronic Push-button Switch Midnight Dash    Extra-safe Powerpoint Gun Metal    Powerpoint & USB Charger Ghost Gum    Extra-Safe Autoswitch Powerpoint 5 O'Clock Olive

### SOFT-TOUCH COLOURS



### BASICS



### METALLICS



View the full Linea range at [hpm.com.au](http://hpm.com.au) or [hpm.co.nz](http://hpm.co.nz)

## EXCEL LIFE

Excel Life is for cool, calm and casual living. With a timeless style, the Excel Life collection blends effortlessly with all interiors.



Rocker Switch with LED Rings    Push-button Dimmer Liquid Gloss Diesel    Powerpoint & USB Charger    TV & Internet Socket    Double Powerpoint & Type A + C USB Charger Black

### NEUTRALS



### LIQUID GLOSS



View the full Excel Life range at [legrand.com.au](http://legrand.com.au) or [legrand.co.nz](http://legrand.co.nz)

Whether you want streamline and chic, or bold and adventurous, these exclusive products let you RETHINK your style.

## OUTDOOR SWITCHES & SOCKETS

### AQUA

Tried and tested, Aqua is a popular range of outdoor weatherproof switches and power points for everyday use around the house.



Double Powerpoint



Single Powerpoint    1 Gang Switch

See more at [hpm.com.au](http://hpm.com.au) or [hpm.co.nz](http://hpm.co.nz)

### SOLIROC

A perfect complement to architecturally designed environments, Soliroc is a corrosion resistant and stylish range of outdoor weatherproof switches and sockets.



Double Powerpoint



1 Gang Switch    Light Sensitive Switch

See more at [legrand.com.au](http://legrand.com.au) or [legrand.co.nz](http://legrand.co.nz)

## HPM LIGHTING

Lighting is a powerful tool for creating ambience. Whether you're after garden lights or a decorative wall light, we have quality options to suit your home.



Twin LED Floodlight with Sensor



HPM LED CALLA Step Light and ZINNIA Starlight Aluminium



LED Pendant Lights



LED Colour Changing Downlight



LED Exterior Up/Down Light Stainless Steel



LED Garden Light

See more at [hpm.com.au](http://hpm.com.au) or [hpm.co.nz](http://hpm.co.nz)

## HPM VENTILATION

Keep cool or stay toasty with fans and heat lamps.



Wall Exhaust Fan



Instant Heat 4



Fanlight



Ceiling Fan Stainless Steel

See more at [hpm.com.au](http://hpm.com.au) or [hpm.co.nz](http://hpm.co.nz)



INTERCOMS

Designed in Italy by the renowned BTicino, choose from the best in communication innovation.

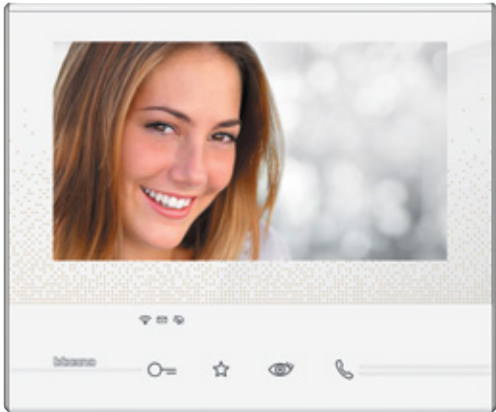

BTicino Classe 300 Wifi Intercom

Open the front door from your smartphone or tablet wherever you are. With a stunning 7" touchscreen display and wireless connectivity, the Classe 300 Wifi Intercom kit combines modernity and innovation.



Linea 3000 Entry Panel



7" Handsfree colour video monitor

See more at [legrand.com.au](http://legrand.com.au) or [legrand.co.nz](http://legrand.co.nz)

HOME AUTOMATION

Your home lighting management and energy monitoring can be expanded to include further home automation functions.



Legrand MyHOME 10" Multimedia Touchscreen



Temperature Control



Sound Diffusion



Blind & Curtain Control



Lighting Control

See more at [legrand.com.au](http://legrand.com.au) or [legrand.co.nz](http://legrand.co.nz)

NUVO SOUND SYSTEM

The NUVO wireless multi-room audio system is based around robust band wireless players, which communicate with your Internet access point and one another. This means that you can access your music or stream audio for countless online options. The player also features a USB port for flash/hard drives.



See more at [legrand.com.au](http://legrand.com.au) or [legrand.co.nz](http://legrand.co.nz)







# KEEPING YOU CONNECTED IN THE 21<sup>ST</sup> CENTURY

Staying connected in your home is more important now than ever. In this digital age we use online services everyday to make life easier. Why not **RETHINK** your electrical plan, ensuring the highest level of functionality and convenience for your home. Legrand ELIOT solutions enable you to interact with products in a simple and efficient way: that's the Internet of Things! ELIOT lets you personalise the configuration of your home, even remotely, by creating scenarios that suit your needs. It multiplies the functions of electrical equipment to create a simpler, more fluid experience in your home. Legrand ELIOT solutions keep you connected now and in the future as your family grows and changes.



BTicino Classe 300 Wifi Intercom



“The function of design is letting design function.”

MICHA COMMEREN *Designer*





# TAKE YOUR HOME TO THE NEXT LEVEL WITH MyHOME® AUTOMATION



Imagine you're at work. You receive a message on your smart phone telling you there's someone at your front door. A mobile app that connects to your CCTV shows you that it's that important delivery you've been waiting for. You can talk to the driver, unlock your front door remotely, and ask him to drop off the package, while viewing what's going on. Welcome to the new age of home automation.

Whether you're a technology enthusiast, want to make sure your home will attract the best resale price, or simply like convenient, time-saving products, MyHOME automation makes your home work for you.

MyHOME automation systems allow the electrical systems in your home – such as lighting, air-conditioning, audio entertainment, security systems and video intercoms – to communicate with each other. All these separate electrical functions can be controlled together from central points in your home, or from external locations via apps. For example, a 'Goodnight' switch in your bedroom allows you to turn off all the lights in the house and close the blinds.

Tailor your home to your personal needs and make life easier. Everyday.



REMOTE CONTROL FROM WHEREVER YOU ARE -  
THE COUCH, THE POOL, THE OFFICE.



Create comfort and ease in your home. Here are some of the brilliant things a MyHOME system can do for you:

01



## OFF SITE REMOTE CONTROL

Linking your intercom system to your mobile phone is a smart way to speak to visitors when you're not home. You can even let people into your home to drop off parcels, clean or do repairs and watch them on your phone or laptop.

02



## AUTO 'GOODBYE'

Including a 'Goodbye' scenario is a great idea. This function allows you to turn off all lighting, air-conditioning, floor heating and close blinds to save energy and turn on the third-party alarm system when you leave the house for extra security.

03



## SAFETY 'LIVED IN'

A 'Lived In' scenario is great for when you're on holiday. This setting activates blinds and lighting at specific times to deter intruders.

04



## AUTO 'GOODNIGHT'

A 'Goodnight' scenario can turn off all lighting and shut all blinds, shutters and curtains when you go to bed.

05



## APP CONTROL

Using a laptop, iPad, iPhone or Android phone, you can control sound, lighting, temperature and your intercom without having to leave the comfort of your couch.

06



## AUTO 'MOVIE'

Program a 'Movie' scenario to set the scene: dim the lights and close the blinds for perfect viewing.

07



## ENERGY MONITORING

View total everyday usage data from any touchscreen. Being aware is the first step to saving energy.

08



## TIMERS & SENSORS

By using timers and sensors, have your blinds, shutters and curtains open and close according to natural light levels outside - this can help reduce energy consumption and keep your home more comfortable.

09



## ENTERTAINMENT

By programming an 'Entertaining' scenario, you can create the perfect ambience. One button can dim the lights on your verandah, start your 'Party' playlist and illuminate your garden lights.

10



## TEMPERATURE CONTROL

Remotely turning on your home air-conditioning using your computer ensures your home is the perfect temperature upon arrival.

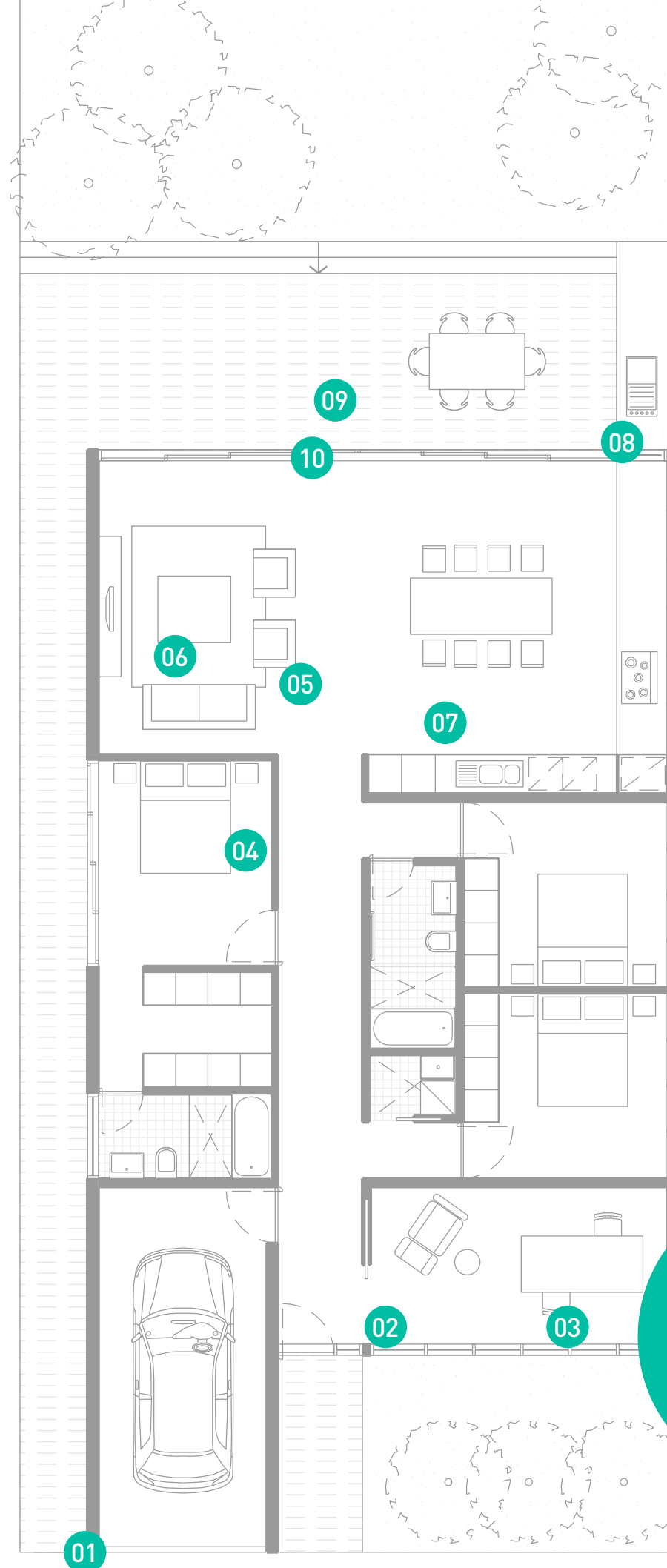

## KEY DIFFERENCES OF A MyHOME SYSTEM

### MODULARITY & EXPANDABILITY

Unlike other systems, you only need to install and pay for the functions you want, not a huge complex system you'll never use. Once you have the basics installed you can add additional functions later. All of the functions might not be within your budget initially, but can be added easily in the future.

### UNIFORMITY

Conventional devices, such as powerpoints, share the same design aesthetic as automation control devices, so all of your switch plates will look great together.

### EASE OF USE

The MyHOME automation system is easy to install, saving you on installation costs. Anyone can use the system, from techy types to technophobes.

### WHY MyHOME?

MyHOME systems are for everyone, regardless of budget and skillfulness with technology. They are the future.

### KEEN TO LEARN MORE?

Speak with a MyHOME installer. They can customise a system to suit your lifestyle and budget. Our Customer Service team can help you find an accredited installer, give them a call on:  
1300 369 777 (for Australia)  
0800 476 009 (for New Zealand)

HAVE ALL YOUR ELECTRICAL DEVICES WORKING IN HARMONY FOR EASIER LIVING



# ROOM-BY-ROOM

## PRODUCT CHECKLIST

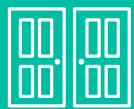

### ENTRANCE

- Intercom
- Motion sensor for lighting
- 2 way switch for hallway
- Skirting lights for hallway
- Downlights
- Up/down lights
- Smoke detector
- Powerpoints



### CONVENIENCE TIP

Consider an outdoor motion sensor to automatically turn on the light when you arrive home so you can easily find your keys and safely walk along paths and steps.



### SAFETY TIP

Use a video intercom system to screen visitors and keep your family from opening the door to strangers.



### PLANNING TIP

Remember to add powerpoints in hallways and entrance areas for activities like vacuum cleaning.

## HANDY HINTS



### KITCHEN

- Intercom
- Downlights
- Dimmer switch
- Multiple powerpoints
- USB charger
- Internet & phone socket
- Ceiling exhaust fan



### TIDY TIP

Avoid the clutter of cords by adding powerpoints in your pantry. Charge items such as mobile phones and handheld vacuum cleaners behind closed doors.



### COMFORT TIP

Light dimmers in your kitchen are perfect for switching between the brighter light needed during cooking, and mood lighting for dining.



### DESIGN TIP

Arteor mirror finishes look great on glossy splashbacks.



### LIVING ROOM

- Downlights
- Dimmer switch
- Powerpoints on all walls
- TV socket
- Speaker sockets
- Ceiling fans
- Ceiling speakers
- Internet & phone socket



### PLANNING TIP

Think about where you'll place your furniture then ensure your powerpoints and TV sockets will be easily accessible without needing to move heavy sofas and cabinets. And add a few extra sockets in case you reconfigure your furniture.



### CONVENIENCE TIP

If you like working on your laptop whilst watching TV, install a data socket nearby for a more reliable connection than WiFi.



### COMFORT TIP

Installing dimmers in your living room gives you the freedom to create the ultimate space for relaxation. Brighter lights for reading, or mood lighting for snuggling-up.



### BEDROOM

- Dimmer switch
- Ceiling fan
- Multiple powerpoints
- USB charger
- Internet socket
- Motion sensor for W.I.R light
- Panel light



### PLANNING TIP

Kids rooms require planning. The needs of children change as they grow older, so ensure you install enough powerpoints to cater for changing bedroom layouts, and data sockets for the internet.



### COMFORT TIP

Using lamps and dimmers in your bedroom gives you the freedom to alternate the way you utilise this space. Applying make-up or dressing may require brighter lighting, while relaxing calls for a softer hue.



### CONVENIENCE TIP

Ask yourself what you'll need to plug-in at your bedside - lamp, clock radio, phone charger, laptop - and ensure you have enough powerpoints. Consider a data socket for the internet.

## PRODUCT CHECKLIST



### BATHROOM

- Heat, light & exhaust fan unit
- Ceiling speakers
- Heated towel rail timer
- Weatherproof switch
- Powerpoints with RCBO protection
- Starlights



### PLANNING TIP

Powerpoints for electrical devices in the bathroom are paramount. Keeping them a safe distance from water sources is important, so be sure to think carefully.



### COMFORT TIP

Ventilation is critical in bathrooms to control condensation and mould. Make sure ventilation capacity matches the size of the room and plan for cross ventilation to maximise efficiency.



### TIDY TIP

Keep your vanity benchtop free of cords; consider installing a powerpoint in the cupboard for tidy charging of electric toothbrushes and shavers.



### HOME OFFICE

- Light switch
- Oyster light
- Ceiling fan
- Ceiling speakers
- Internet & phone socket
- Multiple surge protected powerpoints



### COMFORT TIP

Enjoy working to music with a multi-room audio system. Wall or ceiling speakers will give a richer sound than your computer, and keep your desk free of cords and bulky desk speakers.



### PLANNING TIP

Ceiling fans will help you control the heat generated by computers and monitors.



### SAFETY TIP

Surge protected powerpoints provide a safeguard for expensive appliances.



### OUTDOOR LIVING

- Motion sensor for lighting
- Flood light
- Outdoor speakers
- Ceiling fan
- Outdoor powerpoints and switches
- Up/down lights
- Twin LED floodlight



### COMFORT TIP

If you love to entertain, then consider networking your sound system outdoors. Turn the music up during summer soirées.



### PLANNING TIP

Weatherproof powerpoints for portable appliances such as power tools, edge trimmers, party equipment and garden lighting are essential for outdoor areas.



### CONVENIENCE TIP

Lighting near your washing line makes it easier and safer to hang out or bring in your washing after dark.



### GARAGE

- Light switch
- Fluorescent lights
- Motion sensor for lighting
- Flood light with sensor for outdoor lighting
- Digital time switch
- NBN box



### CONVENIENCE TIP

Time switches are a brilliant idea. Garden lights, pool lighting and irrigation systems can all be controlled to turn on and off at set times.



### CONVENIENCE TIP

Install a sensor to automatically activate the light when the garage door opens.



### PLANNING TIP

Ensure you have access to all the benefits of the new National Broadband Network with an NBN junction box.

## HANDY HINTS



# CHECKLIST

[illegible]



In this brochure we introduce you to products from the leading electrical brands: Legrand, the iconic Australian brand HPM, and BTicino. All of these brands belong to the global Legrand Group. Legrand has innovated brilliant electrical solutions for the home for more than 100 years and has a presence in 170 countries. With manufacturing facilities and a dedicated research and development laboratory in Australia, as well as a network of design studios and factories abroad, Legrand is the world leader in the design and manufacture of switches and sockets.



#### **Legrand Australia**

Building 4, Nexus Industry Park  
43-47 Lyn Parade  
Prestons NSW 2170  
1300 369 777  
[www.rethinkelectrical.com.au](http://www.rethinkelectrical.com.au)

#### **Legrand New Zealand**

106 - 124 Target Road  
Glenfield  
Auckland 0627  
0800 476 009  
[www.rethinkelectrical.co.nz](http://www.rethinkelectrical.co.nz)